

ComPRESSED™

BY RAPIDAIR



INDUSTRIAL

**Press Type - All Metal Fitting
Compressed Air Piping System
Rigid Pipe and Flexible Tubing**

SIZES: ½" to 6"

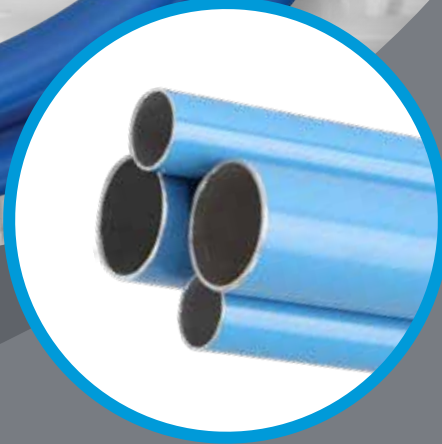



Energy Efficient

- Smooth inner wall and free flowing fittings lower compressed air costs
- Sealed connections means your compressor run time is less



RAPID Installation

- Press fittings are fast to install
- O-ring system gives leak free system performance
- Material/construction for lifetime reliability
- Designed for ease and consistent installation
- May be applied to aluminum and stainless piping and semiflexible tubing

Rigid Pipe System



Fittings Specs 3/4" - 4"

- Press Style
- 304 Stainless Steel
- O-Ring: Nitrile

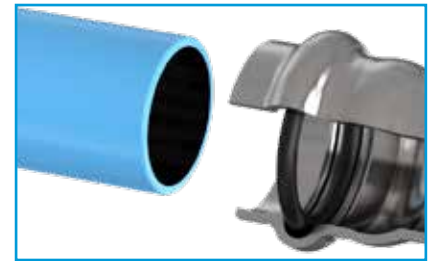

Fittings Specs 4" - 6"

- Lug Style
- Diecast Aluminum Alloy
- Seal: Nitrile
- Powder Coat



Rigid Pipe System Ratings

- 232 PSI Working Pressure
- -4°F to 176°F
- Compressed Air
- Inert Gas
- Vacuum 29 Hg
- Oils, lubricants
- Non-Potable Water
- UL94 HB Fire Resistant
- OSHA Compliant
- ASME B31.1, B31.9
- ASTM B241

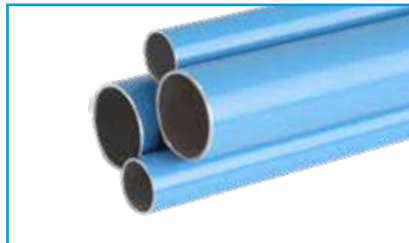

Alum Pipe 3/4" - 6"

- Alloy grade 6063, 5052 T5
- Blue powder coat, RAL5012 outside
- Green powder coat, RAL6018 outside
- Non-chromate conversion coating inside



SS Pipe 3/4" - 2"

- 304 Grade
- Surface Finish OD 0.8μ
- Surface Finish ID 0.4μ



Superior Air Quality

- No corrosion system means longer tool life
- Cools hot compressed air quickly
- Free flow fittings allow maximum air flow capacity

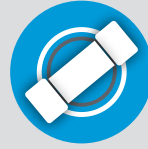

Versatile Applications

- Suitable for all applications and environments
- Connect to any existing piping system
- Compressed air and inert gases

LIFETIME WARRANTY

Flex Tubing System



Fittings Specs 1/2" - 2"

- Press style
- Nickel Plated Brass Body
- Crimp Ring: Stainless Steel
- Double O-Ring: Nitrile

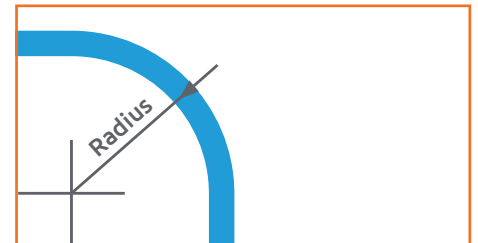
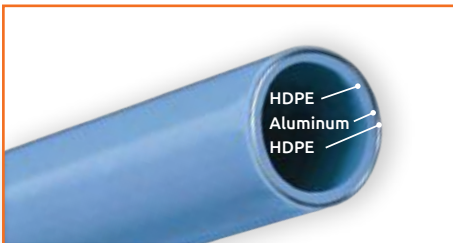

Flex Tubing System Ratings

- 232 PSI Working Pressure
- -40°F to 140°F
- Compressed Air
- Inert Gas
- Vacuum 29 Hg
- Non-Potable Water
- OSHA Compliant
- ASTM F1282
- ASTM F3347

Tubing 1/2" - 2"

- Multi-layer semi flexible tubing
- Inner and outer layer – HDPE
- Center layer – aluminum
- Sizes measured on inside diameter

Bend Radius

- 1/2" Tubing: 4-6 inches
- 3/4" Tubing: 8-10 inches
- 1" Tubing: 10-12 inches
- 2" Tubing: 36-48 inches



Will hold any bent shape.

Warnings

- Compressed air is DANGEROUS if not used properly
- Always use EYE PROTECTION when using compressed air 
- DO NOT POINT compressed air at your body or any person
- Pressurize system SLOWLY
- TURN OFF air compressor when not in use
- CHECK local building codes before installation

 **WARNING:** This product can expose you to chemicals including lead, which is known to the State of California to cause cancer. For more information, go to www.P65Warnings.ca.gov.

Wash hands after handling.

CONTAINS LEAD: MAY BE HARMFUL IF EATEN OR CHEWED.
MAY GENERATE DUST CONTAINING LEAD. KEEP OUT OF THE REACH OF CHILDREN.

Rigid Pipe is NOT:

- For underground burial
- To electrically ground equipment
- To be welded
- To take violent impacts
- To be used where the compressed air temperature is above 176° F
- For environments of caustic or corrosive chemicals

Flex Tubing is NOT:

- To be glued
- To take violent impacts
- To be used where the compressed air temperature is above 140° F
- For environments of caustic or corrosive chemicals
- When using in direct sunlight, cover or paint the plastic tubing to protect from UV exposure (Fittings need no covering and can be exposed)

Installation Tips & Recommendations

Care must be taken on any installation of the FastPipe system. Pipes will be carrying compressed air/gas up to 232 psi. The FastPipe system is only as safe as a thorough installation. Read all installation instructions and watch videos before starting. Below are some tips for a safe installation.

We strongly recommend that the installer contact our tech department for installation questions PRIOR to the installation.

- Assemble all NPT **PIPE THREADS** with two wraps of Thread tape and then pipe sealant which prevents thread galling.
- Support the pipe with clips/ hangers a maximum of **10 FT. SPACING** and on **ONE SIDE OF EACH FITTING**.
- FastPipe can be bent to a maximum of 15° **DO NOT OVER BEND**.
- Any machine/compressor plumbed to the FastPipe must have a **JUMPER HOSE** to reduce vibration.
- Any piping system will expand and contract with temperature changes. Use **EXPANSION JOINTS** to compensate for this movement of aluminum pipe in non-conditioned buildings.
- **DO NOT USE** FastPipe for **PULSING** desiccant dryers or other like equipment.
- **CAUTION** installing inert gas bulk tank systems, gas must be warmed up to FastPipe temperature range.
- Use a strain relief attached to the building for any rubber hose drops attached to the piping.
- **DO NOT** connect quick couplings for air hoses to reducing elbows or tee fittings. The constant connecting/ disconnecting and pulling or air hoses could loosen the fitting. Use the FastPipe **WALL OUTLET** which can be secured to a wall or post. Any hoses attached in the ceiling area to a fitting must use a strain relief attached to the building structure.
- **CHECK** that all fittings are tightened before pressurizing the system for the first time.
- For initial installation, pressurize system **SLOWLY** to 50 psi and check for leaks, then pressurize slowly to MAX 232 psi.
- **CUT** the tubing **STRAIGHT** with the supplied cutter; do not use a hacksaw.
- **CHAMFER** the end of the tubing with the supplied tool. When pushing the tubing into the fitting, the o-ring must insert smoothly. If the end of the tube is sharp, it will cut the o-ring and **CAUSE LEAKS**. Use a spray bottle with a couple of drops of dish soap and fill it with water for lubrication.
- **TUBING** must be **INSERTED** into the fitting fully to the shoulder inside.

**PRODUCTS MANUFACTURED BY THE SELLER CARRY A WARRANTY.
SEE WWW.RAPIDAIRPRODUCTS.COM FOR MORE DETAILS.**

Pipe

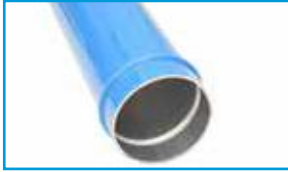
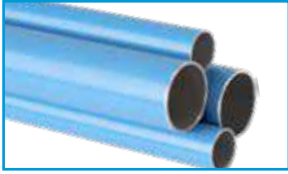

SIZE	MM	BLUE ALUM	GREEN ALUM	STAINLESS 304	ALUM LENGTH	ALUM WEIGHT	SS LENGTH	SS WEIGHT
3/4"	20mm	F1000	F1000G	F1000SS	19 ft. 2 in.	2.6 lbs.	19 ft.	6.0 lbs.
1"	25mm	F2000	F2000G	F2000SS	19 ft. 2 in.	4.2 lbs.	19 ft.	7.8 lbs.
1 1/2"	40mm	F4000	F4000G	F4000SS	19 ft. 2 in.	8.8 lbs.	19 ft.	14.7 lbs.
2"	50mm	F5000	F5000G	F5000SS	19 ft. 2 in.	10.1 lbs.	19 ft.	19.0 lbs.
3"	80mm	FI7000	---	---	19 ft. 2 in.	21.0 lbs.	---	---

SIZE	MM	BLUE PART #	OUTSIDE	INSIDE	LENGTH	WEIGHT
4"	100mm	FI8000	4.03 in.	3.79 in.	19 ft. 2 in.	33.5 lbs.
6"	150mm	FI9000	6.04 in.	5.76 in.	19 ft. 2 in.	64.5 lbs.

Wall or Ceiling Installation

- Use pipe clips to secure pipe to any flat surface with mounting screw
- Ceiling or wall mount
- Clip has 5/16" thru hole and hex bore for a 5/16" hex nut
- Hex nut serves as a backer for screws
- Use #10 Drywall Screw or Tapcon
- In horizontal installations, mount clip pivot tab up



MAIN SIZE	PART NUMBER	X DIMENSION
3/4"	F1022 - 10 10/pk	1 5/16"
1"	F2022 - 10 10/pk	7/8"
1 1/2"	F4022 - 10 10/pk	1 15/16"
2"	F5022 - 10 10/pk	1 3/4"
3"	FI7022 each	1 3/8"

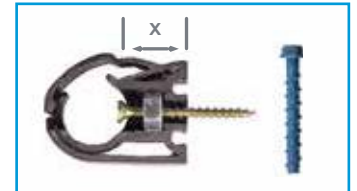

Hanging Installation



Beam Clamp

- Thru hole design
- Works for both 5/16" and 3/8" threaded rod
- 3/4" width opening

PART NUMBER - F0018



Loop Hanger

For 3/8" - 16 threaded rod

MAIN SIZE	PART NUMBER
3/4" & 1"	F0019
1 1/2"	F0020
2"	F0024
3"	F0030
4"	FI0031
6"	FI0032

Cantilever Strut Arm

- 12" overall length
- 1 1/8" standard strut



PART NUMBER - F0021

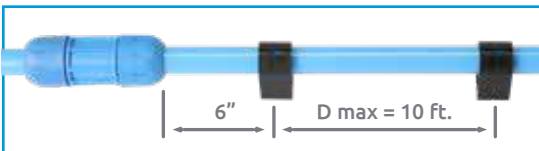

- Hangers or mounting clips should be no more than 10 ft. apart and one must be at least 6" from a fitting
- Do not over tighten cantilever type tube supports, pipe must be allowed to expand and contract slightly in length
- See page 10 for expansion joint guidelines

Strut Cushion Clamp

For 1 1/8" standard strut



MAIN SIZE	PART NUMBER
3/4"	F0017
1"	F0022
1 1/2"	F0023
2"	F0025
3"	FI0028
4"	FI0035
6"	FI0040



3/8" Threaded Rod x 6ft.

PART NUMBER

F0028

3/8" Hex Nut (100 Pack)

PART NUMBER

F0029

Rigid Pipe Press Fittings 3/4"-4"

Union



SIZE	PART NUMBER
3/4"	FC1002
1"	FC2002
1 1/2"	FC4002
2"	FC5002
3"	FC7002
4"	FC8002

90° Reducing Elbow NPT



SIZE	DROP SIZE FEMALE	PART #
3/4"	1/2" NPT	FC1093
1"	1/2" NPT	FC2093

Equal Tee



SIZE	PART NUMBER
3/4"	FC1005
1"	FC2005
1 1/2"	FC4005
2"	FC5005
3"	FC7005
4"	FC8005

Cross



SIZE	PART NUMBER
3/4"	FC1051
1"	FC2051
1 1/2"	FC4051
2"	FC5051
3"	FC7051
4"	FC8051

Reducing Union



SIZE	PART NUMBER
1" x 3/4"	FC2121
1 1/2" x 3/4"	FC4223
1 1/2" x 1"	FC4221
2" x 3/4"	FC5223
2" x 1"	FC5221
2" x 1 1/2"	FC5421
3" x 2"	FC7421
4" x 2"	FC8221
4" x 3"	FC8321

90° Elbow



SIZE	PART NUMBER
3/4"	FC1003
1"	FC2003
1 1/2"	FC4003
2"	FC5003
3"	FC7003
4"	FC8003

Reducing Tee



MAIN SIZE	DROP SIZE	PART NUMBER
1"	3/4"	FC2107
1 1/2"	3/4"	FC4206
1 1/2"	1"	FC4207
2"	3/4"	FC5206
2"	1"	FC5207
3"	2"	FC7207
4"	3"	FC8207

Slide Union



SIZE	PART NUMBER
3/4"	FC1023
1"	FC2023
1 1/2"	FC4023
2"	FC5023
3"	FC7023
4"	FC8023

45° Elbow



SIZE	PART NUMBER
3/4"	FC1004
1"	FC2004
1 1/2"	FC4004
2"	FC5004
3"	FC7004
4"	FC8004

Reducing Tee NPT



MAIN SIZE	DROP SIZE FEMALE	PART NUMBER
3/4"	1/2" NPT	FC1009
1"	1/2" NPT	FC2009
1 1/2"	1/2" NPT	FC4009
2"	1/2" NPT	FC5009

End Cap



SIZE	PART NUMBER
3/4"	FC1006
1"	FC2006
1 1/2"	FC4006
2"	FC5006
3"	FC7006
4"	FC8006

Rigid Pipe Press Fittings 3/4"-4"

Inline Valve



SIZE	PART NUMBER
3/4"	FC1111
1"	FC2222
1 1/2"	FC4444
2"	FC5555
3"	FC7777
4"	FC8888

Female NPT



MAIN SIZE	FEMALE THREAD	PART NUMBER
3/4"	3/4" NPT	FC1120
1"	1" NPT	FC2220
1 1/2"	1 1/2" NPT	FC4420

Male NPT



MAIN SIZE	MALE THREAD	PART NUMBER
3/4"	1/2" NPT	FC1018
3/4"	3/4" NPT	FC1118
1"	1/2" NPT	FC2018
1"	3/4" NPT	FC2118
1"	1" NPT	FC2218
1 1/2"	1" NPT	FC4218
1 1/2"	1 1/2" NPT	FC4418
2"	1 1/2" NPT	FC5418
2"	2" NPT	FC5518
3"	2" NPT	FC7618
3"	3" NPT	FC7718
4"	4" NPT	FC8818

Swivel Female NPT



SIZE	PART NUMBER
3/4"	FC1033
1"	FC2033
1 1/2"	FC4033
2"	FC5033

Flange Connections



SIZE	PART NUMBER
3"	FC7900
4"	FC8900

ANSI Class 150 Flange

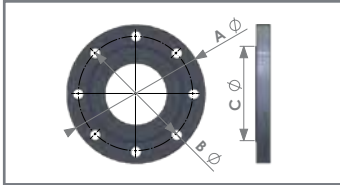

SIZE	A	B	C	BOLT HOLES
3"	7.50	6.00	5.00	4
4"	9.00	7.50	6.18	8

Multiport Wall Outlet

(HAS BOTTOM MOISTURE DRAIN)

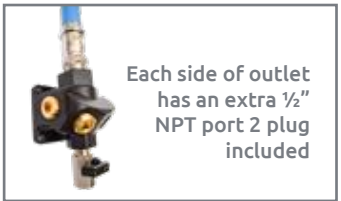

Each side of outlet has an extra 1/2" NPT port 2 plug included



INLET TUBING SIZE	OUTLET SIZE FEMALE	PART NUMBER
3/4"	(4x) 1/2" NPT	FC1024
1"	(4x) 1/2" NPT	FC2024

Multiport Wall Outlet w/ Shutoff

(HAS BOTTOM MOISTURE DRAIN)



INLET TUBING SIZE	OUTLET SIZE FEMALE	PART NUMBER
3/4"	(4x) 1/2" NPT	FC1024V
1"	(4x) 1/2" NPT	FC2024V

Single Port Wall Outlet



INLET TUBING SIZE	OUTLET SIZE FEMALE	PART NUMBER
3/4"	1/2" NPT	FC1014
1"	1/2" NPT	FC2014

Thru Wall

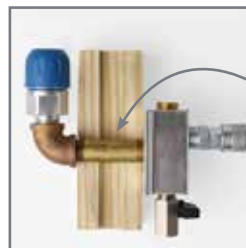

Customer Supplied 1/2" NPT Nipple length varies per wall thickness

INLET TUBING SIZE	OUTLET SIZE FEMALE	PART NUMBER
3/4"	(1x) 1/2" NPT	FC1024W
1"	(1x) 1/2" NPT	FC2024W

Rigid Pipe Press Tools 3/4"-4"

Press Fit Installation Tools



SIZE	PART NUMBER	
Jaw Set	FC0162	3/4"-2" JAWS
3/4" Jaw	FC0165	SINGLE JAW
1" Jaw	FC0166	SINGLE JAW
1 1/2" Jaw	FC0167	SINGLE JAW
2" Jaw	FC0168	SINGLE JAW
3" Jaw	FC0169	SINGLE JAW
4" Jaw	FC0170	SINGLE JAW

O-Ring (10 pack)



SIZE	PART NUMBER
3/4"	FC1076-10
1"	FC2076-10
1/2"	FC4076-10
2"	FC5076-10
3"	FC7076-10
4"	FC8076-10

Cordless Press Tool



SIZE	PART NUMBER
3/4"-2"	FI9020 32KN 7200 LBF
3"-4"	FI9050 80KN 18,000 LBF

Manual Press Tool



SIZE	PART NUMBER
3/4"-2"	FC0190 32KN 7200 LBF

Pipe Cutter



SIZE	PART NUMBER
3/4"-2"	F0140
3"	FI0148
4"-6"	FI0149

Debur Tool



MAIN SIZE	PART NUMBER
3/4" & 1"	F0142
3/4" thru 2"	F0141

Debur Tool



SIZE	PART NUMBER
3"	FI0153
4"	FI0154
6"	FI0155

FastPipe Installation 3/4"-4"



Cut Pipe to length with tubing cutter (cut must be square) (DO NOT USE HACK SAW)



Debur the end of the pipe outside and inside (a smooth edge allows easy fitting assembly and no damage to the fitting O-ring)



Mark end of pipe for the proper insertion depth

3/4" Fittings:	1 1/4 inches
1" Fittings:	1 3/8 inches
1 1/2" Fittings:	2 inches
2" Fittings:	2 1/2 inches
3" Fittings:	2 3/4 inches
4" Fittings:	3 1/4 inches



Insert pipe into fitting until pipe bottoms out



Crimp



Finished crimp

Rigid Pipe Lug Style Fittings 4"-6"

Union



SIZE	PART NUMBER
4"	FI8002
6"	FI9002

90° Elbow



SIZE	PART NUMBER
4"	FI8003
6"	FI9003

45° Elbow



SIZE	PART NUMBER
4"	FI8004
6"	FI9004

Equal Tee



SIZE	PART NUMBER
4"	FI8005
6"	FI9005

Threaded Adapter



MAIN SIZE	DROP SIZE FEMALE	PART NUMBER
4"	2" NPT	FI8221
4"	3" NPT	FI8321
6"	2" NPT	FI9221
6"	3" NPT	FI9331

Reducing Union



SIZE	PART NUMBER
6" x 4"	FI9821

Inline Valve



SIZE	PART NUMBER
4"	FI8888
6"	FI9999

End Cap



SIZE	PART NUMBER
4"	FI8006
6"	FI9006

Flange Connections



SIZE	PART NUMBER
4"	FI8900
6"	FI9900

ANSI Class 150 Flange Flange Gasket

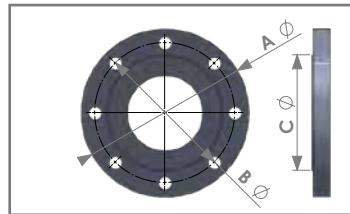

SIZE	A	B	C	BOLT HOLES
4"	9.00	7.50	6.18	8
6"	11.00	9.50	8.50	8



SIZE	PART NUMBER
4"	FI8905
6"	FI9905

Deburr Tool



SIZE	PART NUMBER
4"	FI0154
6"	FI0155

Lug Tool Jaw Set (4" & 6")



FI9021

Pipe Cutter (4" thru 6")



FI0149

Cordless Lugging Tool



LUG STYLE 4"-6" FI9020 32KN 7200 LBF

Rigid Pipe Drops

Saddle Drop



MAIN SIZE	DROP SIZE	PART NUMBER
1"	3/4"	FC2110
1 1/2"	3/4"	FC4110
1 1/2"	1"	FC4210
2"	3/4"	FC5110
2"	1"	FC5210
3"	3/4"	FC7110
3"	1"	FC7210
4"	1"	FI8312
6"	1"	FI9312

Saddle Drop NPT



MAIN SIZE	DROP SIZE	PART NUMBER
1"	1/2" NPT	FC2012
1 1/2"	1/2" NPT	FC4012
2"	1/2" NPT	FC5012
3"	1/2" NPT	FI7012
4"	1" NPT	FI8312
6"	1" NPT	FI9312



MAIN SIZE	DRILL BIT	REPLACEMENT GASKET
1"	3/16" F0043	FC2210C
1 1/2"	3/4" F0044	FC4210C
2"	3/4" F0044	FC5210C
3"	3/4" F0044	FC7210C
4"	1 5/16" F0045	FI8210C
6"	1 5/16" F0045	FI9210C



STEP 1



STEP 2



STEP 3



STEP 4

Saddle Drop Installation

- System must be de-pressurized before installing
- To prevent chips from entering the pipe interior, stop drilling occasionally and blow out chips, grease the end of the drilling tool

1. Position saddle drop opposite the side of the pipe that needs the hole
Tighten securely and mark the pipe by the raised locating mark on the fitting
Mark the pipe both horizontally & vertically along the fitting edge
2. Drill thru one side of the pipe with the drill bit, using the hole in the fitting as a locator
3. Insert the saddle drop gasket into the molded cavity
4. Position the saddle drop over the drilled hole with aligning marks, tighten securely
5. Attach the necessary drop pipe or threaded adapter

Jumper Hose



STAINLESS STEEL

MALE NPT X SWIVEL FEMALE NPT

MAIN SIZE	LENGTH	PART NUMBER
1½"	18"	F0225
1½"	36"	F0226
2"	36"	F0227
3"	36"	F0228



RUBBER

MALE NPT X SWIVEL FEMALE NPT

MAIN SIZE	LENGTH	PART NUMBER
½"	2 ft.	F0212
½"	3 ft.	F0213
¾"	2 ft.	F0214
¾"	3 ft.	F0215
¾"	5 ft.	F0221
1"	2 ft.	F0216
1"	3 ft.	F0217



STAINLESS STEEL

FLANGE

MAIN SIZE	LENGTH	PART NUMBER
4"	36"	F0234
6"	36"	F0236

Expansion Joints



FEMALE NPT X FEMALE NPT

SIZE	PART NUMBER
1"	F0615
1½"	F0616
2"	F0617



FEMALE NPT X FEMALE NPT

SIZE	PART NUMBER
3"	F0619



FLANGE X FLANGE

SIZE	PART NUMBER
4"	F0621
6"	F0622

Any piping system will expand and contract with temperature changes, use this guide for installation of expansion joints to compensate for this movement of aluminum pipe in non-conditioned buildings

TEMP CHANGE	MAXIMUM STRAIGHT RUN DISTANCE						
	¾"	1"	1½"	2"	3"	4"	6"
10°F	700 ft.	600 ft.	550 ft.	500 ft.	300 ft.	250 ft.	225 ft.
20°F	500 ft.	460 ft.	420 ft.	370 ft.	230 ft.	190 ft.	175 ft.
35°F	350 ft.	310 ft.	280 ft.	250 ft.	150 ft.	125 ft.	100 ft.
55°F	260 ft.	230 ft.	200 ft.	190 ft.	120 ft.	95 ft.	75 ft.
70°F	200 ft.	190 ft.	170 ft.	150 ft.	100 ft.	75 ft.	50 ft.

Transition Fittings



Pipe

+

Tubing

PART NUMBER	PIPE SIZE	TUBING SIZE
FC1050	¾"	½"
FC1075	¾"	¾"
FC1100	¾"	1"
FC2050	1"	½"
FC2075	1"	¾"
FC2100	1"	1"

Flex Tubing Press Fittings 1/2"-2"

Tubing



SIZE	PART # (BLUE)	PART # (GREEN)	OUTSIDE	INSIDE	LENGTH
1/2"	M6026	M6026G	.63 in.	.50 in.	100 ft
1/2"	M6027	M6027G	.63 in.	.50 in.	300 ft
3/4"	M6030	M6030G	.98 in.	.80 in.	100 ft
3/4"	M6031	M6031G	.98 in.	.80 in.	300 ft
1"	M6032	M6032G	1.26 in.	1.02 in.	100 ft
1"	M6033	M6033G	1.26 in.	1.02 in.	300 ft
2"	M6520	---	2.50 in.	2.00 in.	200 ft



Mount Clips

10 pack

SIZE	PART #	SPACING
1/2"	M8064	3 ft
3/4"	M8065	5 ft
1"	M8066	5 ft



Strut Clamp

for 1 5/8" strut

SIZE	PART #	SPACING
1/2"	ST010T062	3 ft
3/4"	F0022	5 ft
1"	ST035NP100	5 ft
2"	ST068T250	8 ft

Union



SIZE	PART NUMBER
1/2" x 1/2"	MC8021
1/2" x 3/4"	MC8024
1/2" x 1"	MC8020
3/4" x 3/4"	MC8022
3/4" x 1"	MC8025
1" x 1"	MC8023
2" x 2"	M8525

Elbow



SIZE	PART NUMBER
1/2"	MC8080
3/4"	MC8067
1"	MC8068
2"	M8535

Tee



SIZE	PART NUMBER
1/2"	MC8010
3/4"	MC8011
1"	MC8012
2"	M8530

Replacement O-Ring 10 Pack



SIZE	PART NUMBER
1/2"	MC8054-10
3/4"	MC8055-10
1"	MC8056-10
2"	MC8059-10

Reducing Tee



SIZE	PART NUMBER
3/4" x 1/2" x 3/4"	MC8014
1" x 1/2" x 1"	MC8016
1" x 3/4" x 1"	MC8018

Reducing Tee Female NPT



SIZE	PART #
1/2" x 1/2" NPT x 1/2"	MC8019
3/4" x 1/2" NPT x 3/4"	MC8078
1" x 3/4" NPT x 1"	MC8089
2" x 1" NPT x 2"	M8531

Flex Tubing Press Fittings 1/2"-2"

Male NPT



SIZE	PART #
1/2" x 3/8" NPT	MC8001
1/2" x 1/2" NPT	MC8002
3/4" x 1/2" NPT	MC8005
3/4" x 3/4" NPT	MC8003
1" x 3/4" NPT	MC8015
1" x 1" NPT	MC8004
2" x 1" NPT	M8541
2" x 2" NPT	M8542

Male NPT Elbow



SIZE	PART #
1/2" x 1/2" NPT	MC8085
3/4" x 1/2" NPT	MC8086
3/4" x 3/4" NPT	MC8088
1" x 1" NPT	MC8090

Inline Valve



SIZE	PART #
1/2"	MC8038
3/4"	MC8039
1"	MC8040

Single Port Elbow



SIZE	PART #
1/2"	MC8009

Female NPT



SIZE	PART #
1/2" x 1/2" NPT	MC8006
3/4" x 3/4" NPT	MC8007

End Cap



SIZE	PART #
1/2"	MC8026
3/4"	MC8027
1"	MC8028

Single Port Wall Outlet



Multiport Wall Outlet w/ Shutoff



Thru Wall



TUBING INLET SIZE	SINGLE PORT	SINGLE PORT W/ SHUTOFF	OUTLET NPT	THRU WALL
1/2"	MC3810	MC3810V	1/4"	MC3810W
3/4"	MC7510	MC7510V	1/2"	MC7510W

TUBING INLET SIZE	MULTI PORT	MULTI PORT W/ SHUTOFF	OUTLET NPT
1/2"	MC8200	MC8200V	1/2"x4
3/4"	MC8201	MC8201V	1/2"x4
1"	MC8203	MC8203V	1/2"x4



Press Tool
MC8092 1/2" - 3/4" - 1"



Press Tool
M8590 2"



Cutter
M8551 2"



Bevel Tool
M8595 2"



Cutter
M8051 1/2" - 3/4" - 1"



Straightening Tool
M8097 1/2" - 3/4" - 1"



Bevel Tool
M8095 1/2" - 3/4" - 1"



Bender Tool
M8096 1/2" - 3/4" - 1"

Accessories

Safety Quick Coupler



Quick Coupler Plugs



30 CFM INDUSTRIAL STYLE TYPE M

PART NUMBER	MALE THREAD SIZE
K7221	1/4" NPT
K7241	1/2" NPT

PART NUMBER	FEMALE THREAD SIZE
K7220	1/4" NPT

PART NUMBER	MALE THREAD SIZE
K5221	1/4" NPT

PART NUMBER	FEMALE THREAD SIZE
K5220	1/4" NPT

70 CFM INDUSTRIAL STYLE TYPE H

PART NUMBER	MALE THREAD SIZE
K9231	3/8" NPT
K9241	1/2" NPT

PART NUMBER	FEMALE THREAD SIZE
K9230	3/8" NPT
K9240	1/2" NPT

PART NUMBER	MALE THREAD SIZE
K8221	1/4" NPT
K8231	3/8" NPT
K8241	1/2" NPT

PART NUMBER	FEMALE THREAD SIZE
K8220	1/4" NPT
K8230	3/8" NPT
K8240	1/2" NPT



Filter Regulator

PART NUMBER	PORT SIZE
K93215	3/8" NPT
K93216	1/2" NPT
K93217	3/4" NPT
K93218	1" NPT



Vertical Filter Regulator

PART NUMBER	PORT SIZE
K96075	3/4" NPT
K96050	1/2" NPT



Push on rubber hose

PART NUMBER	SIZE	LENGTH
F0238-160	3/8"	160 ft.
F0238-FT	3/8"	By the ft.
F0250-160	1/2"	160 ft.
F0250-FT	1/2"	By the ft.



Female Swivel NPT

PART NUMBER	HOSE SIZE	THREAD SIZE
F0243	3/8"	1/4" NPT
F0244	3/8"	1/2" NPT
F0252	1/2"	1/2" NPT



Male NPT

PART NUMBER	HOSE SIZE	THREAD SIZE
F0240	3/8"	1/4" NPT
F0241	3/8"	3/8" NPT
F0242	3/8"	1/2" NPT
F0251	1/2"	1/2" NPT



Hose Reel

PART NUMBER	SIZE	LENGTH
R-03050	3/8"	50 ft.
R-03075	3/8"	75 ft.
R-05050	1/2"	50 ft.
R-05100	1/2"	100 ft.



Aluminum Manifolds

PART NUMBER	INLET SIZE	# OF PORTS	OUTLET PORTS
H-50-25-4	1/2" NPT	4	1/4" NPT
H-50-25-5	1/2" NPT	5	1/4" NPT
H-50-50-4	1/2" NPT	4	1/2" NPT
H-50-50-5	1/2" NPT	5	1/2" NPT
H-75-50-3	3/4" NPT	3	1/2" NPT
H-75-50-4	3/4" NPT	4	1/2" NPT
H-75-50-5	3/4" NPT	5	1/2" NPT
H-75-75-3	3/4" NPT	3	3/4" NPT
H-75-75-4	3/4" NPT	4	3/4" NPT
H-75-75-5	3/4" NPT	5	3/4" NPT
H-100-75-3	1" NPT	3	3/4" NPT
H-100-75-4	1" NPT	4	3/4" NPT
H-100-75-5	1" NPT	5	3/4" NPT

Moisture Separator Filter



Moisture Separator 230 psi Max, 35°F -176°F

M=Remove water up to one quart per minute, auto float drain

Pressure Regulator

R=Pressure Regulator, adjustable to 125 psi

Compressed Air Filters 230 psi Max, 35°F -176°F ISO8573.1:2010

	PARTIAL REMOVAL MICRON	OIL REMOVAL PPM	GAUGE	AUTO DRAIN
P=Pre Filter	5.0	5.0	YES	YES
X=General Purpose	1.0	0.5	YES	YES
Y=Coalescing (Oils)	0.01	0.01	YES	YES
A=Activated Carbon (Odor)	0.01	0.003	YES	YES

THREAD SIZE	FLOW RATE	M MOISTURE SEPARATOR UNIT	P FILTER UNIT	P REPLACE-MENT ELEMENT	X FILTER UNIT	X REPLACE-MENT ELEMENT	Y FILTER UNIT	Y REPLACE-MENT ELEMENT	A FILTER UNIT	A REPLACE-MENT ELEMENT
¼" NPT	15 CFM	AM-025	AF-025P	AE-025P	AF-025X	AE-025X	AF-025Y	AE-025Y	AF-025A	AE-025A
½" NPT	60 CFM	AM-050	AF-050P	AE-050P	AF-050X	AE-050X	AF-050Y	AE-050Y	AF-050A	AE-050A
¾" NPT	90 CFM	AM-075	AF-075P	AE-075P	AF-075X	AE-075X	AF-075Y	AE-075Y	AF-075A	AE-075A
1" NPT	150 CFM	AM-100	AF-100P	AE-100P	AF-100X	AE-100X	AF-100Y	AE-100Y	AF-100A	AE-100A
1½" NPT	350 CFM	AM-150	AF-150P	AE-150P	AF-150X	AE-150X	AF-150Y	AE-150Y	AF-150A	AE-150A
2" NPT	500 CFM	AM-200	AF-200P	AE-200P	AF-200X	AE-200X	AF-200Y	AE-200Y	AF-200A	AE-200A
3" NPT	1100 CFM	AM-300	AF-300P	AE-300P	AF-300X	AE-300X	AF-300Y	AE-300Y	AF-300A	AE-300A



3-Stage w/ Pressure Regulator

125 psi max outlet pressure

Point of Use Combination Units

THREAD SIZE	FLOW RATE	2 STAGE	2 STAGE W/R	3 STAGE	3 STAGE W/R	WALL MOUNT
¼" NPT	15 CFM	AA-025MY	AA-025MYR	AA-025MYA	AA-025MYAR	AA-025W
½" NPT	60 CFM	AA-050MY	AA-050MYR	AA-050MYA	AA-050MYAR	AA-050W
¾" NPT	90 CFM	AA-075MY	AA-075MYR	AA-075MYA	AA-075MYAR	AA-075W
1" NPT	150 CFM	AA-100MY	AA-100MYR	AA-100MYA	AA-100MYAR	AA-100W



Refrigerated Air Dryer – Digital Cycling

High Efficiency, Microprocessor controlled cycling 3 in 1 Heat Exchanger
Integrated Inlet Filter (X) and Outlet Filter (Y)

FLOW RATE	THREAD SIZE	PART NUMBER	VOLTS
25 CFM	½" NPT	RNC-0025	115v
50 CFM	¾" NPT	RNC-0050	115v
75 CFM	¾" NPT	RNC-0075	115v
125 CFM	1½" NPT	RNC-0125	115v

ComPRESSED™

BY RAPIDAIR



Ask us about our new
RapidAir System Designer

Design your air system in minutes!

